



Partners to success

Walter Dünner SA SWISS TOOLING
2740 Moutier Switzerland
Tél:+41 32 493 11 52 Fax: +41 32 493 46 79



Die neue Kraft
Made in Germany
für die Zerspanungstechnik



JR TOOL ApS Tel: +45 75 82 90 66
Skomagervej 3c Fax: +45 75 83 99 77
DK-7100 VEJLE



High-Tech / High-Touch
La marque de confiance
Die Marke des Vertrauens
La marca di fiducia

Outillage pour MAIER ML-ProLine Tooling for MAIER ML-ProLine

Werkzeuge für MAIER ML-ProLine Ustensili per MAIER ML-ProLine

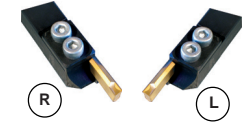
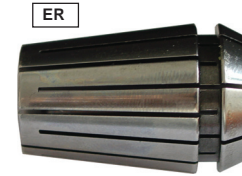
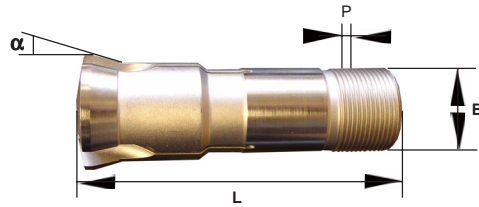

Machines Maschinen Machines Macchine	Canon type Führungsbüchse Typ Bush type Boccola tipo	Références MAIER	B x L	α	P	\varnothing	\varnothing	\varnothing	Pince coupée Spindelstock Headstock collet Pinza per fantina	P. contre-poupée** P.-up Abgreifspindel** P.-up collet** P. contra-fantina**	Contre-perceur Hinterbohrer Rear and drilling Contro foratore	Perceur frontal Frontbohrapparat	Outils pour revolver Werkzeugrevolver	Burins Stähle Tools Utensili
ML	12C B212A	166.001	18x60	30°	M16x1	13	11.11	9	F17/79-185E	F17/79	ER11			
	16C J7AR	39.001	22x68	16°	M22x1	18	16.50	12.50	F17/79-185E	F22/71	ER11			
	16D J7AR	39.001	22x68	16°	M22x1	18	16.50	12.50	F17/79-185E	F22/71	ER11	ER11		
	20 B261	22.001	28x82	16°	M25x1	20	17.50	14	F25/64-145E	F25/64		ER16	ER16	
	26 B227	451.001	34x87.5	10°	M34x1	26	22	18	F32/221-161E	F32/221		ER16	ER16	
	32 J9	T299	42x82	16°	M40x1	32	28	23	F37/740-1536E	F37/740		ER16	ER16	

*Canon utilisé exclusivement en canon tournant
*Führungsbüchse, nur mit umlaufende Lünette gebraucht
*Guide bush used with rotating bush only
*Boccola adoperata soltanto nella boccola rotante

**Exécution avec nez rallongé
**Ausführung mit verlängertem Nase
**Execution with extended nose
**Esecuzione con lungo naso

L = A gauche
L = Links
L = Left hand
L = A sinistra
R = A droite
R = Rechts
R = Right hand
R = A destra