

 **TSUGAMI CORPORATION**

Partners to success

**Walter Dünner SA**

SWISS MADE  
Tooling for  
Tsugami lathes

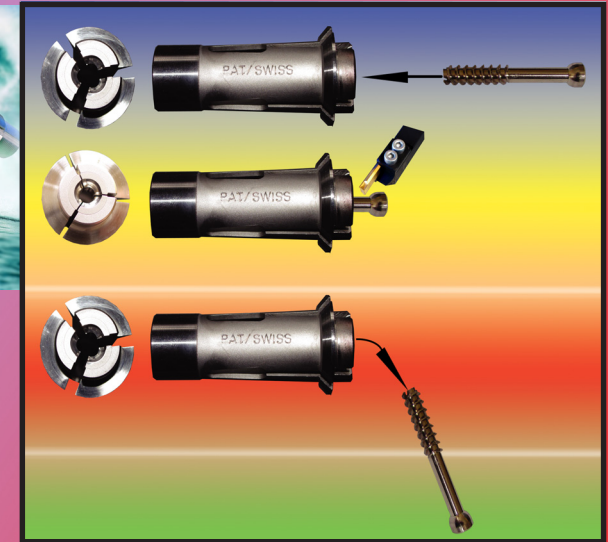
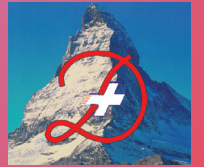

**JR TOOL ApS** Tel: +45 75 82 90 66  
Skomagervej 3c Fax: +45 75 83 99 77  
DK-7100 VEJLE

**Walter Dünner SA** SWISS TOOLING

CH-2740 Moutier Switzerland  
Tél: +41 32 493 11 52 Fax: +41 32 493 46 79

# Outillage pour nouvelles machines TSUGAMI

## Tooling for new TSUGAMI machines

# Werkzeuge für neue TSUGAMI Maschinen

## Utensili per nuove macchine TSUGAMI

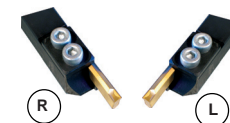
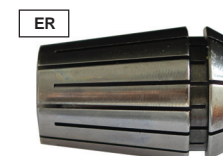
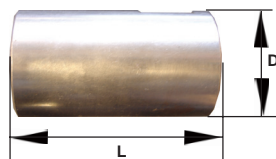
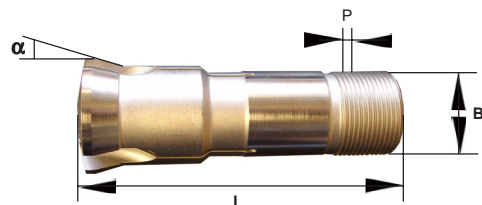

Machines  
Maschinen  
Machines  
Macchine

Canon type  
Führungsbüchse Typ  
Bush type  
Boccola tipo

P

BxL

α

∅

∅

∅

Douilles  
Hülse  
Sleeve  
Bussola  
D x L

Pince poupée  
Spindelstock  
Headstock collet  
Pinza per fantina

P. contre-poupée\*\*  
P.-up Abgreifspindel\*\*  
P.-up collet\*\*  
P. contro-mandrino\*\*

Pince frontale  
Frontalzange  
Front collet  
Pinza frontale

Pince arrière  
Hinterzange  
Back collet  
Pinza dietro

Pince latérale  
Seitenzange  
Side collet  
Pinza laterale

Chien type  
Spannfinger Typ  
Toggle type  
Marteletti tipo

Burins  
Stähle  
Tools  
Utensili

BA	20	B260	M25x1	28x81	30°	20.00	18.00	15.00	F25/64 145E	F25/64 145E	ER16	ER16	ER16(TO1,2)/ER20(TO3)	16x16R/L
	26	B227	M34x1	34x87.5	10°	26.00	22.00	18.00	F32/221 161E	F32/221 161E	ER16	ER16	ER16(TO1,2)/ER20(TO3)	16x16/20x20R/L
BN	20	B260	M25x1	28x81	30°	20.00	18.00	15.00	F25/64 145E	F25/64 145E	ER16	ER16	ER16(TO1,2)/ER20(TO3)	16x16R/L
BO	07	J4	M10x0.75	11x53	16°	8.00	6.00	5.00	F10/86 109E					7x7R/L
	12	B238	M24x1	24x61	30°	18.00	15.00	12.00	F22/71 140E	F22/71 140E	ER11	ER11	ER11	12x12xR/L
	18	B238	M24x1	24x61	30°	18.00	15.00	12.00	F22/71 140E	F22/71 140E	ER11	ER11	ER16(TO1)/ER11(TO2,3)	12x12R/L
BU	26	B227	M34x1	34x87.5	10°	26.00	22.00	18.00	F32/221 161E	F32/221 161E	ER16	ER16	ER16(TO1,2)/ER20(TO3)	16x16/20x20R/L
BS	12	B238	M24x1	24x61	30°	18.00	15.00	12.00	F22/71 140E	F22/71 140E	ER11	ER11	ER11	12x12R/L
	18	B238	M24x1	24x61	30°	18.00	15.00	12.00	F22/71 140E	F22/71 140E	ER11	ER11	ER16(TO1)/ER11(TO2,3)	12x12R/L
	20	B260	M25x1	28x81	30°	20.00	18.00	15.00	F25/64 145E	F25/64 145E	ER16	ER16	ER16(TO1,2)/ER20(TO3)	16x16R/L
	26	B227	M34x1	34x87.5	10°	26.00	22.00	18.00	F32/221 161E	F32/221 161E	ER16	ER16	ER16(TO1,2)/ER20(TO3)	16x16R/L
	32	B232	M38x1	41x54	10°	32.00	27.00	22.00	F37/740 1536E	F37/740 1536E	ER16	ER16	ER16(TO1,2)/ER20(TO3)	16x16R/L
BU/MU	26	B227	M34x1	34x87.5	10°	26.00	22.00	18.00	F32/221 161E	F32/221 161E				16x16/20x20R/L
	38	B240	M46x1	48x81	10°	38.00	33.00	32.00	F37/740 1536E	F37/740 1536E				16x16/20x20R/L
BW	07	J4	M10x0.75	11x53	16°	8.00	6.00	5.00	F10/86 109E					7x7R/L
	12	B238	M24x1	24x61	30°	18.00	15.00	12.00	F22/71 140E	F22/71 140E	ER11	ER11	ER11	12x12xR/L
	20	B260	M25x1	28x81	30°	20.00	18.00	15.00	F25/64 145E	F25/64 145E	ER16	ER16	ER16(TO1,2)/ER20(TO3)	16x16R/L
NB	12	B238	M24x1	24x61	30°	18.00	15.00	12.00	F22/71 140E	F22/71 140E	ER11	ER11	ER11	12x12R/L

Acieus modèles	Alte Modelle	Old models	Vecchi modelli
----------------	--------------	------------	----------------

NP-4W	J4	M10x0.75	11x53	16°	8.00	6.00	5.00	DJ4. 15x50	F10/86 109E					7x7R/L
NT-NP	11	B212A	M16x1	18x60	30°	12.00	10.00	7.00	DB212A. 22x44	F15/580 120E				12x12R/L
	16	J7A	M19x1	22x68	16°	18.00	15.00	12.00	DJ7A. 30x64	F22/71 140E				12x12R/L
	16-II	B238	M24x1	24x61	30°	16.00	14.00	11.00		F22/71 140E				12x12R/L
	16-II	J7A	M19x1	22x68	16°	18.00	15.00	12.00		F22/71 140E				12x12R/L
	17	B238	M24x1	24x61	30°	18.00	15.00	12.00		F22/71 140E				12x12R/L
	17	J7A	M19x1	22x68	16°	18.00	15.00	12.00		F22/71 140E				12x12R/L
	20	B214	M32x1	32x71	30°	20.00	18.00	15.00		F25/64 145E				16x16R/L
	20-II	B260	M25x1	28x81	30°	20.00	18.00	15.00		F25/64 145E				16x16R/L
	32	J9	M40x1	42x81	16°	32.00	27.00	22.00	DJ9. 52x71	F37/740 1536E				16x16R/L
	32-II	J9	M40x1	42x81	16°	32.00	27.00	22.00		F37/740 1536E				16x16R/L
S20		B260	M25x1	28x81	30°	20.00	18.00	15.00		F25/64 145E				16x16R/L

\*Canon utilisé exclusivement en canon tournant  
\*Führungsbüchse nur mit umlaufende Lünette gebraucht  
\*Guide bush used with rotating bush only  
\*Boccola adoperata soltanto nella boccola rotante

\*\*Exécution avec nez rallongé  
\*\*Ausführung mit verlängertem Nase  
\*\*Execution with extended nose  
\*\*Esecuzione con lungo naso

L = A gauche  
L = Links  
L = Left hand  
L = A sinistra  
R = A droite  
R = Rechts  
R = Right hand  
R = A destra